

# The Crosby Arboretum

Mississippi State University Extension Service

Quarterly News Journal

Spring 2016

30.2

## THE QUAKING BOG EDUCATIONAL EXHIBIT

Last July, the Crosby Arboretum Foundation received a \$21,938 Five Star and Urban Waters Restoration Grant from the National Fish and Wildlife Foundation in partnership with Southern Company, the parent company of Mississippi Power, to fund the construction for a Quaking Bog Educational Exhibit. This will be the first constructed quaking bog wetland educational exhibit in the U.S.

Quaking bogs are temperate wetlands that are usually comprised of a thick layer of sphagnum peat, and can range to many feet in depth. The term “quaking” refers to the feeling one has when standing upon a deep layer of peat supported by water. Such bogs are more common to northern areas of the North American and European continents. Along the Gulf Coast, they are usually found within or adjacent to pitcher plant bogs managed by prescribed fire. The Arboretum exhibit will measure about 1,200 square feet, and is located between the South Pitcher Plant Bog Exhibit and the Bayhead Forest Exhibit, adjacent to an area that is used as a firebreak for controlled burning for the Savanna and Bog Exhibits. Hydrologically, it is the wettest area of the pitcher plant bog.

Soil will be excavated from the exhibit area, ranging from a depth of six inches to one foot, and replaced with peat moss. Living sphagnum peat moss will be installed as the top layer. In order for visitors to experience the feeling of a quaking bog, a floating bridge will be installed over this exhibit and will rest upon the water level, the center portion of a 115' x 8' boardwalk.

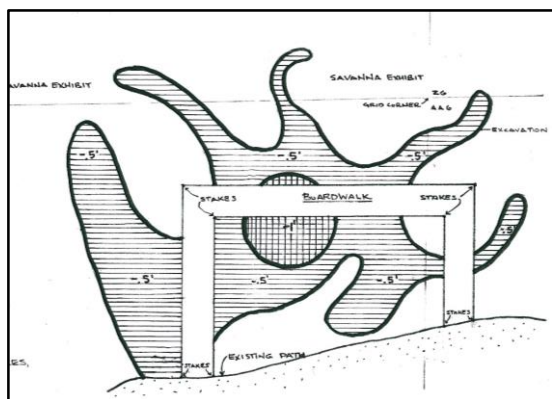

The refined Quaking Bog layout plan illustrates the 115 linear foot boardwalk passing over the exhibit area.



Bob Brzuszek and Foundation president Ruth Cook study the Quaking Bog Educational Exhibit layout plan.

In January 2016, Professor Bob Brzuszek’s Ecological Planting Design (LA 4514/6514) class visited the Arboretum. Emily Finley, Preston Moses, Anas Bdour, Michael Keating, Riyadh Mohsin, Amy Counterman and Ying Qin spent the day staking out the Quaking Bog Educational Exhibit. This spring semester, the students will be gaining valuable experience through their study and implementation of the exhibit. Dr. Tim Schauwecker’s Landscape Contracting and Management students are also developing design details for the bridge project in their spring Construction Cost Estimating class (LA 4724).

The goal is for exhibit completion by June 30. Excavation is planned to be finished by mid-April, with boardwalk construction to follow. The center bridge construction is projected to begin in April and to be finished by May 31.



Students in Professor Brzuszek’s LA 4514/6514 Ecological Planting Design class staked out the exhibit area this January.



## The Crosby Arboretum Mississippi State University

A regional arboretum representing the native flora of the Pearl River Drainage Basin in Mississippi and Louisiana.

Picayune, Mississippi, USA

### Director's Notebook:

The signs of the coming spring are with us daily now, from woolly sunbonnets raising their faces to the sun as it travels across the sky, flowering red maple trees, delicate white bog violets, and Elliot blueberry's bell-shaped blooms that beckon to passing bees. And speaking of bees, we are most grateful that **Buddy Broadway** has been willing to tend to our very busy bee hive, which was donated to the Arboretum last year by member **D. L. Wesley**.

**The Crosby Arboretum Foundation Art Show** is returning for its second year this April. A two-day art exhibit will culminate with the Strawberries and Cream Festival on Sunday, April 3, when awards will be announced. The annual Art Show event was originally proposed by long-time friend of the Arboretum, and now volunteer, **Will Sullivan**, who is here every week to work on reviewing and organizing our historical archives.

We simply could not operate the Arboretum without the assistance and support from our volunteers and members. This issue is an excellent example of the many persons who contribute to furthering our mission. Although we recently lost our Senior Curator, staff member **Kim Johnson** has stepped in to take over the responsibilities of volunteer coordinator and is doing an excellent job with the program. She has already made major improvements in our methods for recruiting and communicating with volunteers, and in the recording and reporting of volunteer hours.

*- Patricia Drackett, Director  
The Crosby Arboretum, MSU Extension Service*



Despite the wet conditions in January and February, **Terry Johnson** and his burn crew volunteers were able to conduct a prescribed fire in both the North and South bogs this year.



*Michelle Berdux* installs fabric in the new beds. The Partners crew has removed all of the existing materials in the Children's Garden, and we look forward to their planting project in April!

### CHILDREN'S BUTTERFLY GARDEN RENOVATION PROJECT

We are pleased to report that the **Pearl River County Partners in Leadership Class** has chosen to perform a major renovation of the Arboretum's Children's Butterfly Garden for a community group project. All of the existing materials were removed, including most of the plant material, the raised bed wood borders, and soil. After re-leveling the area to address some low water-holding concerns, the new beds were built in a design that will allow visitors the opportunity to walk through and enjoy the garden. The newly renovated garden area will serve as an attractive venue for conducting children's programs and workshops.

The inside of the new beds were lined with landscape cloth to help retain the soil/media along the bottom and corners of the raised wood sides. The beds will be filled with soil and composted pine bark and, after installation of a micro-irrigation system, will be ready for planting to begin in April.

A diverse selection of plant material will added, to attract a wide array of butterfly species native to South Mississippi as well as those who migrate through our area. **The Poplarville Upper Elementary Conservation Club** will be assisting with the planting and are currently making butterfly information markers to put in the beds. The community project is being led by the Partners in Leadership Team consisting of **Michelle Berdux**, **Sharon Guepet**, and **Laurie Langlois**.



## The Crosby Arboretum Mississippi State University

A regional arboretum representing the native flora of the Pearl River Drainage Basin in Mississippi and Louisiana.

Picayune, Mississippi, USA

## Thank you, Annual Appeal Contributors

**Capt. Cornelius and Loretta Acheson**  
**Jerry and Beth Alexander**  
**Mrs. Donald (Anne) Bradburn**  
**Phelan and Fay Bright**  
**Howard, Henrietta, and Karen Bruggers**  
**Robert and Claire Conlin**  
**Ruth Cook**  
**Michael and Carol Fitzwilliam**  
**Jo Ann Fleming**  
**David Gurney**  
**Ray and Jennifer Heffner**  
**James and Joann Johnston**  
**Dennis and Mary Martin**  
**Robert and Cindy Murchison**  
**Lyle E. Nelson**  
**Dr. Neil Odenwald**  
**Julia O'Neal**  
**David and Jan Oreck**  
**Gordon and Laura Oussett**  
**Thomas L. Price**  
**Chris Schneidau and Judy Schwartz**  
**David and Janet Schlauderaff**  
**Ann Steinmetz and Bruce Campbell**  
**Will and Genie Sullivan**  
**William Thames**  
**Gene Yeager**

The Crosby Arboretum wishes to express our sincere gratitude to these persons for their generous contributions to our 2015 Annual Appeal. To date, a total of \$3,020 has been raised toward the construction of a deck at the intersection of the Slough Trail and the new Swamp Forest trail that leads north to the Gum Pond Educational Exhibit. The deck will be similar to the one in Cypress Cove near our south pitcher plant bog, and will include bench seating. Located near an Atlantic white cedar grove, the deck area is only a short stroll from the Visitor Center, and will offer a peaceful, shady location to sit during warmer weather.

Professor Bob Brzuszek, Mississippi State University Department of Landscape Architecture, has developed a concept plan for the new bridge, and recently staked out the location for the future deck construction. North of the future deck, you will find six handsome cypress bridges built by grounds manager Terry Johnson, assisted by Arboretum volunteer Tom Heim, and staff member Jarrett Hurlston.

We are grateful that so many of you are committed to seeing our educational exhibits completed, and we have sincerely enjoyed watching many long-anticipated portions of the Arboretum's exhibits become a reality over these last few years.

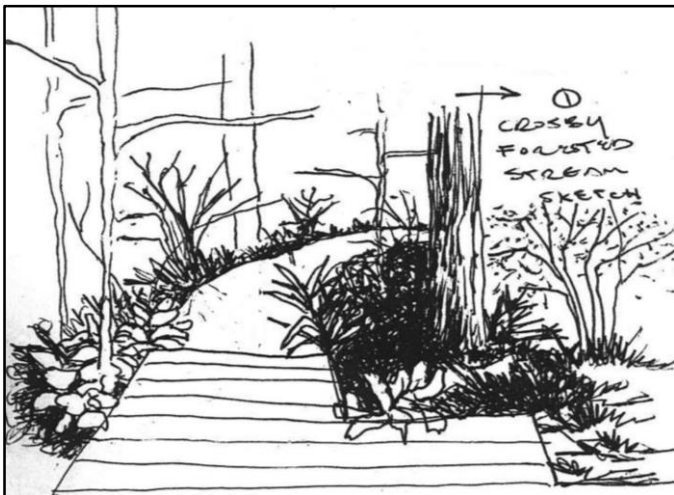

*Concept sketch by Bob Brzuszek of the future deck to be built at the south junction of the Swamp Forest Trail.*

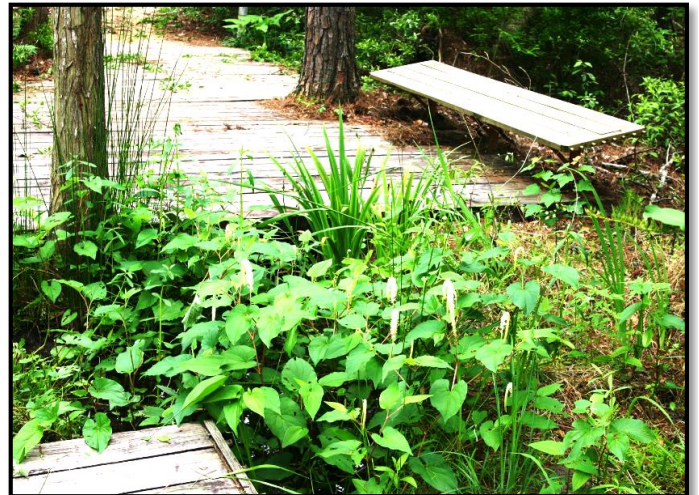

*The new deck will contain seating, and will have a similar appearance to the existing Cypress Cove deck.*

## PLANT PROFILE: PINGUICULA SPP.

The Arboretum's new Quaking Bog Educational Exhibit will provide a new habitat on the site to introduce rare wetland plants such as Chapman's butterwort (*Pinguicula planifolia*, left) and Southern butterwort (*Pinguicula primuliflora*, right). These carnivorous species have sticky leaves that trap and digest insect prey, providing nutrients unavailable to the plants in acidic, nutrient-poor soils. The cupped leaves are covered with tiny hairs that secrete a mucous-like substance, giving the surface a wet appearance believed to attract and snare insects in search of water. Once trapped, digestive enzymes are released that dissolve the insects, and the nutrients are absorbed by the plant. Butterworts are spring bloomers that occur in very wet habitats such as seep slopes, ditches, and bogs. The leaves of *P. planifolia* will turn a reddish color in sunlight. *P. primuliflora* has become a popular carnivorous plant, and is available in the trade.



[http://www.southeasternflora.com/view\\_flora.asp?plantid=539](http://www.southeasternflora.com/view_flora.asp?plantid=539)  
[http://www.southeasternflora.com/view\\_flora.asp?plantid=836#](http://www.southeasternflora.com/view_flora.asp?plantid=836#)

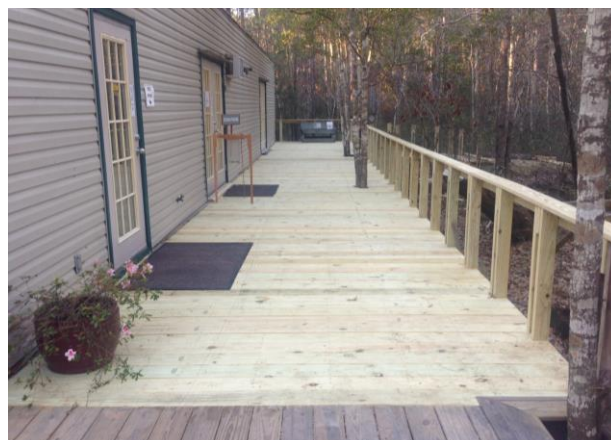

Arboretum Volunteer **Tom Heim**'s carpentry skills proved invaluable in the construction of the new Visitor Center deck!

The News Journal is a quarterly publication of The Crosby Arboretum, Mississippi State University Extension Service. Journal subscriptions may be obtained with membership at the Arboretum. Printed on recycled paper with  $\geq 30\%$  postconsumer waste recycled fiber. Journal may be received electronically if desired.

**Please send correspondence to:**

Patricia Drackett, Editor  
 pat.drackett@msstate.edu  
 The Crosby Arboretum  
 P.O. Box 1639  
 Picayune, MS 39466

Mississippi State University does not discriminate on the basis of race, color, religion, national origin, sex, age, disability, or veteran status.

## Membership Application

All contributions are tax deductible to the extent allowed. For more information call: (601) 799-2311 or print form online.

|   |          |
|---|----------|
| _____ Student (send copy of student ID) | \$ 15.00 |
| _____ Individual                        | 30.00    |
| _____ Family                            | 40.00    |
| _____ Donor                             | 100.00   |
| _____ Patron                            | 250.00   |
| _____ Benefactor                        | 1,000.00 |
| _____ Business                          |          |
| _____ Sweetgum                          | 100.00   |
| _____ Sassafras                         | 250.00   |
| _____ Live Oak                          | 500.00   |
| _____ Bigleaf Magnolia                  | 1,000.00 |

\_\_\_\_\_  
Name

\_\_\_\_\_  
Address

\_\_\_\_\_  
City

\_\_\_\_\_  
State Zip Phone

Renewing?  Memberships are for one year.



MISSISSIPPI STATE UNIVERSITY  
EXTENSION

The Crosby Arboretum

Mississippi State University  
 P.O. Box 1639  
 Picayune, MS 39466-1639

# Crosby Arboretum Program Schedule

March – April 2016

## March 2016

### SPRING GALLERY EXHIBIT OPENING WORK BY EDWARD L. BLAKE, JR.



**Saturday, March 5, from 1:00 to 3:00 p.m.**

To celebrate the 30<sup>th</sup> Anniversary of the public opening of The Crosby Arboretum, our Spring Gallery Exhibit will feature work by Edward L. Blake, Jr., designer of the site's award-winning Master Plan and the first director of the Arboretum. Opening event is free to the public. Light refreshments will be served. The exhibit will be on display through May 31.

## FAIRY HOUSE WORKSHOP

**Saturday, March 19, 10:00 to Noon**

Let's create a magical, mystical place for your forest or garden fairy to live this spring in this whimsical hands-on workshop for all ages, led by MSU Extension Professor **Dr. James DelPrince**. All natural materials such as moss, lichen, bark, branches, etc. to create your special fairy dwelling will be provided (You are welcome to bring your own as well.) Children must be accompanied by an adult. Pre-registration is required. Cost for members is \$10 for members; non-members \$15. Register by March 17.

## CONTROLLING WILD HOGS

**Saturday, March 19, 1:00 to 2:00 p.m.**

Feral hogs are a non-native, invasive species which are spreading at an alarming rate, and presenting serious issues for property owners. Learn about the types of damage these nuisance wildlife cause, the variety of control options available, and the history of how these animals came to be such a problem, with Pearl River County Extension Agent **Dr. Eddie Smith**. Free to members; non-members \$5. Register by March 18.

## WILDLIFE DAY (School field day)

**Thursday, March 31, 9:00 a.m. to Noon**

Children will be thrilled to see the array of exhibitors displaying live and preserved animals, while learning how to protect and maintain wildlife in a field day open to area K-12 schools and homeschool groups. Admission is \$2 per child, free to teachers and chaperones. Call by March 30 to schedule an arrival time.

## April 2016

### CROSBY ARBORETUM FOUNDATION ANNUAL ART SHOW

**Sat/Sun, April 2 (10 to 4) & April 3 (10 to 3)**

**Awards announced 2:00 p.m. Sunday**

**At the Strawberries & Cream Festival**

Art submitted to The Crosby Arboretum Foundation Art Show will celebrate the Arboretum and the Piney Woods region of Mississippi. Prizes will be given in all categories, which includes wall art such as paintings and photography; three-dimensional art such as sculpture, ceramics, and heritage crafts (basketry, quilting, weaving, woodcarving etc.). Grades 7 -12 are encouraged to participate in the youth division. Proceeds will benefit the Arboretum's education building fund. Free admission for this community event. For more information, see the entry form at [www.crosbyarboretum.msstate.edu](http://www.crosbyarboretum.msstate.edu).

## STRAWBERRIES & CREAM FESTIVAL

**Sunday, April 3, 1:00 to 3:00 p.m.**

Bring the family! Stroll the Arboretum grounds, and join us to celebrate the history of the old strawberry farm on the lovely Pinecote Pavilion. Ice cream, fresh strawberries, and Picayune Frog Lemonade will be served. Admission is free and open to the public.

## FROGS AND TOADS OF SOUTH MISSISSIPPI

**Saturday, April 16, 10:00 to 11:00 a.m.**

What species of frogs and toads are found in our coastal area? How are they different, and how can you tell them apart? Can you catch warts from a toad? What can really happen if you kiss a frog? Do toads have teeth? Learn these and more fun facts with Pearl River County Extension Agent **Dr. Eddie Smith**. For ages 5 and up. Program is free to members; cost for non-members is \$5, and \$2 for non-members' children. Register by April 15.

# Crosby Arboretum Program Schedule

April – May 2016

## April 2016 *(Continued)*

### SPRING WILDFLOWER FIELD WALK

**Saturday, April 16, 1:00 to 2:00 p.m.**

This is a wonderful time of year to take a few minutes to walk around and appreciate the natural beauty around us. On this field walk on the Arboretum grounds, Director **Pat Drackett** will talk about the native wildflowers and other plants blooming this time of year, and how to incorporate them into your home landscape. Members free. Non-members \$5. Register by April 15.

## SPRING PLANT SALE!



**April 22 & 23**

**10 a.m. - 3 p.m.  
Friday and Saturday  
(Members Admitted  
9:00 a.m. Friday)**

Grab a cart and choose from a wide variety of hand-picked and hard-to-find native trees, shrubs, and perennials for your landscape. Plant professionals will be on hand to help you choose plants suited to your property. **Free admission.** Sale will be adjacent to the Arboretum Visitor Center. Use site Service Entrance.

### The Mississippi Native Plant Society Annual Meeting

will take place at The Crosby Arboretum **April 22-23rd**. Enjoy field trips and presentations! Details will be announced at [www.mississippinativeplantsociety.org](http://www.mississippinativeplantsociety.org)

### THE AMAZING LIFE CYCLE OF THE MONARCH BUTTERFLY

**Saturday, April 30, 10:00 to 11:00 a.m.**

Children will delight in observing the fascinating process as a monarch caterpillar forms a chrysalis, transforms, and begins its life anew as a butterfly in this mesmerizing slide and video presentation. Nature photographer and butterfly enthusiast **Gregory Nordstrom** and wife **Becky** raise monarch butterflies and enjoy sharing their passion with others in fun, educational programs. Free to Arboretum members; non-members \$5. Register by April 29.

## May 2016

### PAINTED POTS FOR MOTHER'S DAY

**Saturday, May 7, 10:00 to 11:00 a.m.**

The perfect Mother's Day Gift for moms who love plants! Children will decorate a clay pot and design a Mother's Day Card using recycled materials. Children must be accompanied by parent or guardian. All materials provided. Members' children \$3; non-members' children \$4. Register by May 5.

### SNAKES, SNAKES, SNAKES!

**Saturday, May 14, 10:00 to 11:00 a.m.**

See and learn all about snakes from "Snake Man" **Terry Vandeventer**, Herpetology Field Associate, Mississippi Museum of Natural Science. Terry is a popular personality for school presentations and on television and radio. Considered the foremost authority on Mississippi snakes, he has guided scientific expeditions in many exotic locations. Program is free to members; non-members \$5, non-members' children \$2.

### ARBORETUM HABITAT WALK: EXPLORING NATIVE PLANTS AND THEIR POLLINATORS

**Saturday, May 21, 10:00 to 11:00 p.m.**

Join **Heather Sullivan**, Mississippi Department of Wildlife, Fisheries, & Parks Botanist, for a spring walk through the Arboretum exhibits. She will discuss the habitats encountered and the native plants within them, with an emphasis on their pollinators. Program is free to members; non-members \$5. Register by May 20.

### BUTTERFLY AND MOTH GARDENING

**Saturday, May 21, 1:00 to 2:30 p.m.**

**Dr. Charles Allen**, accomplished author and authority on coastal native plants, will discuss attracting and feeding butterflies and moths (adults and caterpillars) in your garden, and identifying butterflies and moths in our region. Lists of host and nectar plants will be provided, and tips on installing a moon-moth garden will be covered. Instructions on how to attract and photograph moth species will also be presented. The program is free to members; non-members \$5. Register by May 20.

**Reservations:** Call the Arboretum office at (601) 799-2311 for questions, and to make program reservations.

**Physical Address:** 370 Ridge Road, Picayune, MS 39466

**Hours of Operation:** Wednesday-Sunday, 9:00 a.m.-5:00